

OPTIONAL GLAMOUR
OWNER'S BATH

OPTIONAL COVERED PORCH

1989 Plan

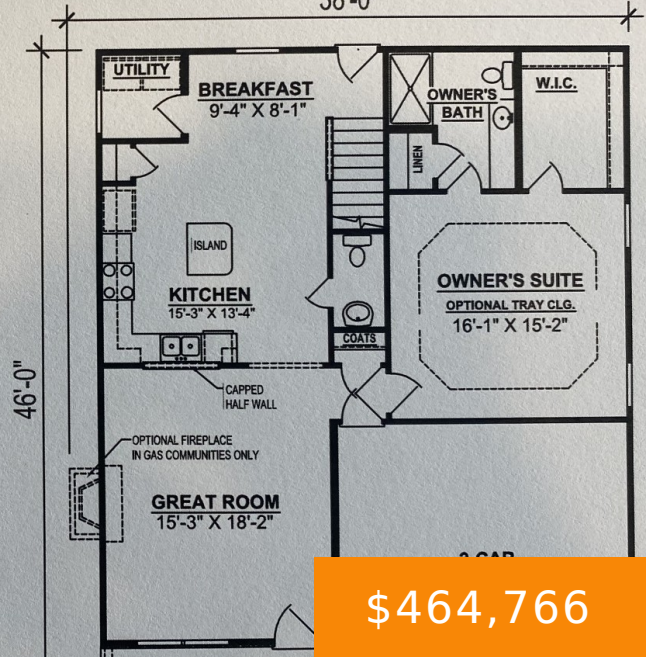
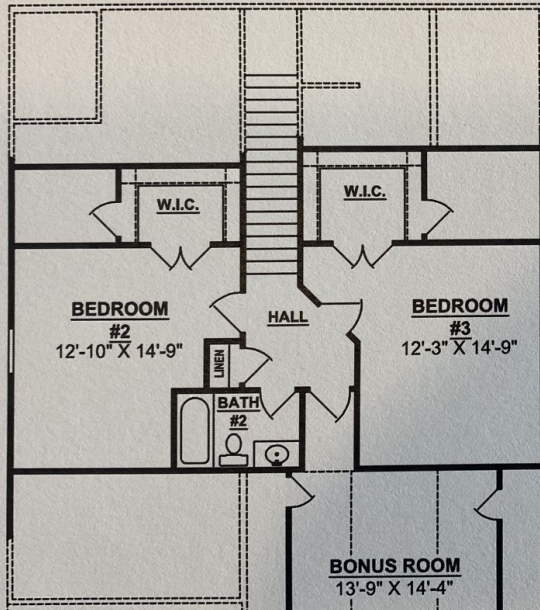

\$464,766

3918 EASTWIND DRIVE, ROCKVALE, TN, US,

<https://haileesellshomes.com>

Plan (1989 Elevation DEF) This beautiful home has Laminate flooring on great rm, kitchen, dining area, and powder rm. Quartz kitchen countertops, staggered height cabinets with crown molding, tile kitchen backsplash, and under cabinet lighting. LARGE walk in closets in all 3 bedrooms. Primary Bathroom features 5 ft. Tiled Shower. Limited Time Special- \$99 Contract [...]

- 3 beds
- 2 baths
- Residential
- Single Family Residence
- Active
- 2002 sq ft

Rooms



Room type	Dimensions
Bedroom 1	16x15
Bedroom 2	14x12
Bedroom 3	14x12
Bonus Room	14x13
Dining Room	9x8
Kitchen	15x13
Living Room	18x15

Building Details

Cooling features: Central Air
NewConstructionYN: Yes
Basement: Slab
Parking: Attached - Front

ParkingTotal: 2
Heating: Heat Pump, Natural Gas
Exterior material: Fiber Cement, Stone

Amenities & Features



Waterfront available: No

AttachedGarageYN: Yes

PoolPrivateYN: No

Utilities: Water Available

Features: Ceiling Fan(s), Primary Bedroom Main Floor

GarageYN: Yes

FireplaceYN: No

ExteriorFeatures: Garage Door Opener

Amenities: Dishwasher, Disposal, Ice Maker, Microwave, Refrigerator

