

Unfinished storage: 175 sq. ft.
 Garage: 893 sq. ft.
 Porches: 459 sq. ft.
 from outside exterior walls. Second floor two story space counted as half. All calculations are approximate.



First Floor



Second Floor

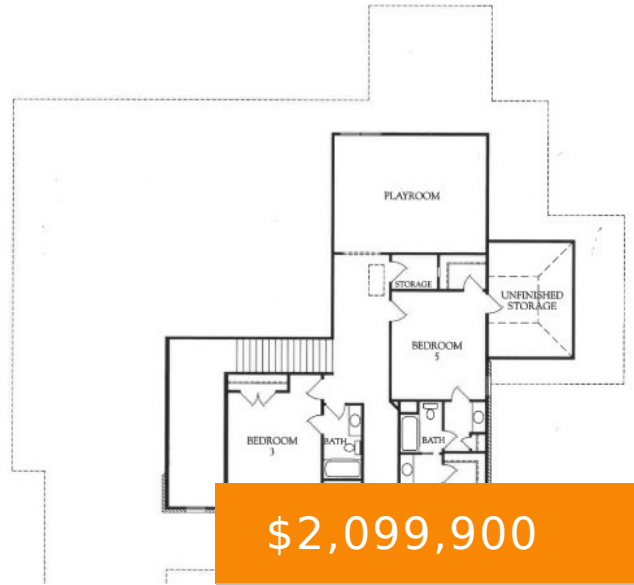

\$2,099,900

1007 LAGUNA DRIVE, FRANKLIN, TN, US,

<https://haileesellshomes.com>

Grand Opening of Award Winning Builder Turnberry Homes
 Newest Estate Neighborhood - Laguna - Excellent Location and
 Only 5 Homesites! Award Winning Builder - Turnberry Homes.
 Popular Nottingham Floor Plan. Vaulted Family Room w/Built-ins,
 Vaulted Office, Primary and Guest Suites on Main Level,
 Expanded Laundry Room - Covered Back Porch, Bonus Room,
 Walk-in Storage, 3-Car [...]

- 5 beds
- 4 baths
- Residential
- Single Family Residence
- Active
- 4763 sq ft

Rooms



Room type	Dimensions
Bedroom 1	18x18
Bedroom 2	15x14
Bedroom 3	14x12
Bedroom 4	14x12
Bonus Room	17x13
Dining Room	16x12
Kitchen	15x14
Living Room	19x19

Building Details

Cooling features: Dual, Electric

ParkingTotal: 3

Heating: Dual, Natural Gas

Exterior material: Brick

Parking: Attached

ArchitecturalStyle: Traditional

NewConstructionYN: Yes

Basement: Crawl Space

Roof: Shingle

Amenities & Features



Waterfront available: No

AttachedGarageYN: Yes

PoolPrivateYN: No

ExteriorFeatures: Garage Door Opener,
Irrigation System

Amenities: Dishwasher, Disposal, Microwave

GarageYN: Yes

FireplaceYN: Yes

Security Features: Smoke Detector(s)

Utilities: Electricity Available, Water Available

Features: Ceiling Fan(s), Entry Foyer, Extra
Closets, High Ceilings, Pantry, Primary Bedroom
Main Floor, Storage, Walk-In Closet(s)

